

TOWN OF WARREN PUBLIC NOTICE
Warren Development Review Board

SITE VISIT:

January 22nd, 2010; 9:00 AM Friday morning

Location: 662 Ridge View Rd, for

Application, 2009-06-SD(continued from January 18th, 2010): Five Lot Major Subdivision, Sketch Plan Review - 662 Ridge View Rd: The applicant, FCC LLC d/b/a FCC Property Holdings LLC requests a sketch plan review hearing for a proposed five (5) lot subdivision on their 21.0 ± acre parcel (Parcel ID 002003-700) in the Rural Residential District This application requires review under Article 2 (Table 2.2) Rural Residential District; Article 6(Subdivision Review), §6.2 (E), (Sketch Plan Review), and Article 7, (Subdivision Standards) of the Warren Land Use and Development Regulations.

These documents were posted on the Town's web site, *www.warrenvt.org*

SITE VISIT:

January 22nd, 2010; 9:00 AM Friday morning

Location: 662 Ridge View Rd, for

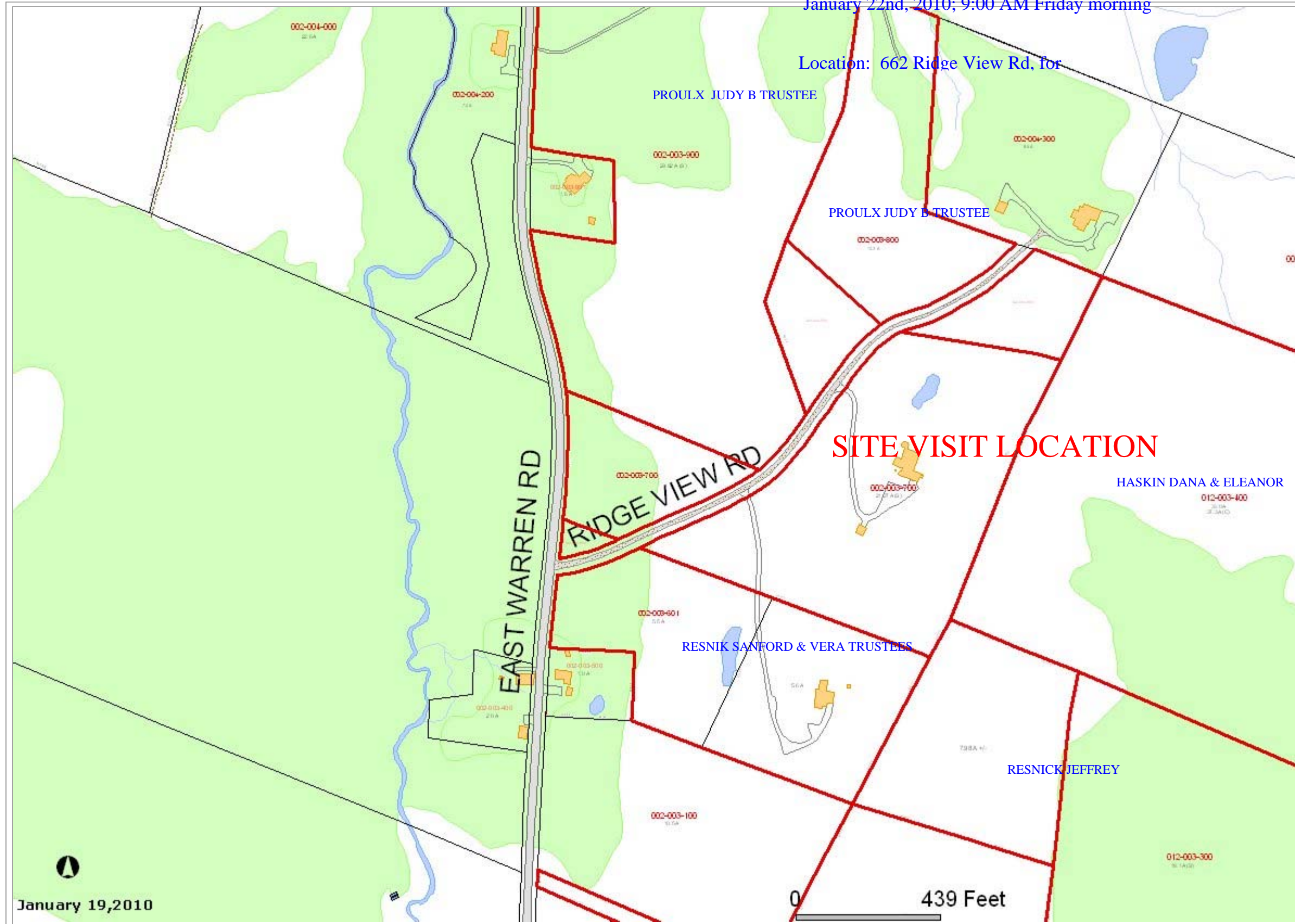

GIS Map Print
My Map

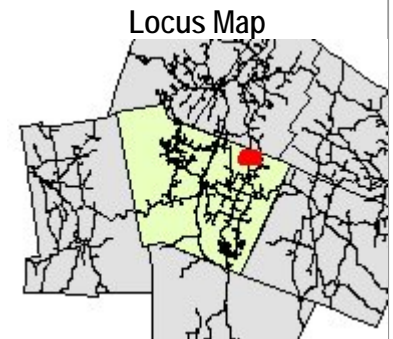

Locus Map

Disclaimer
 The Town of Warren makes no warranty or representation as to the accuracy, timeliness or completeness of any of the data. The Town of Warren shall have no liability for the data or lack thereof, or any decision made or action taken or not taken in reliance upon any of the data.

January 19, 2010